



RIG #114

RATED TO 7000'

LOCATION SIZE

- 250' x 200'

DRAW WORKS

- RATED: 950HP
- BDW 650 W/COMPOUND DRIVE
- (2) 12L 60 SERIES DETROIT ENGINES
- HYDROMATIC BRAKE-PARMAC DOUBLE DRUM 342
- STATIC HOOK LOAD 300,000#'S

MAST

- 103' DRILLING STRUCTURES INC CANTILEVER

SUBSTRUCTURE

- FOUR PIECE BOX ON BOX
- KB 15'
- CLEAR WORKING HEIGHT 11'

MUD PUMPS

- ELLIS WILLIAMS 600

MUD SYSTEM

- 350 BBLS STEEL PITS
- 90 BBLS PREMIX POWERED BY CAT 3304

BOP/ACCUMULATOR

- 11"-3K ANNULAR (LARGER PER WELL BASIS)

TABLE

- SKTOP BREWSTER 20.5"

WATER TANK

- 380BBLS CAPACITY

FUEL TANK

- 5000 GAL

POWER

- 261 KW POWERED BY C-9 CAT

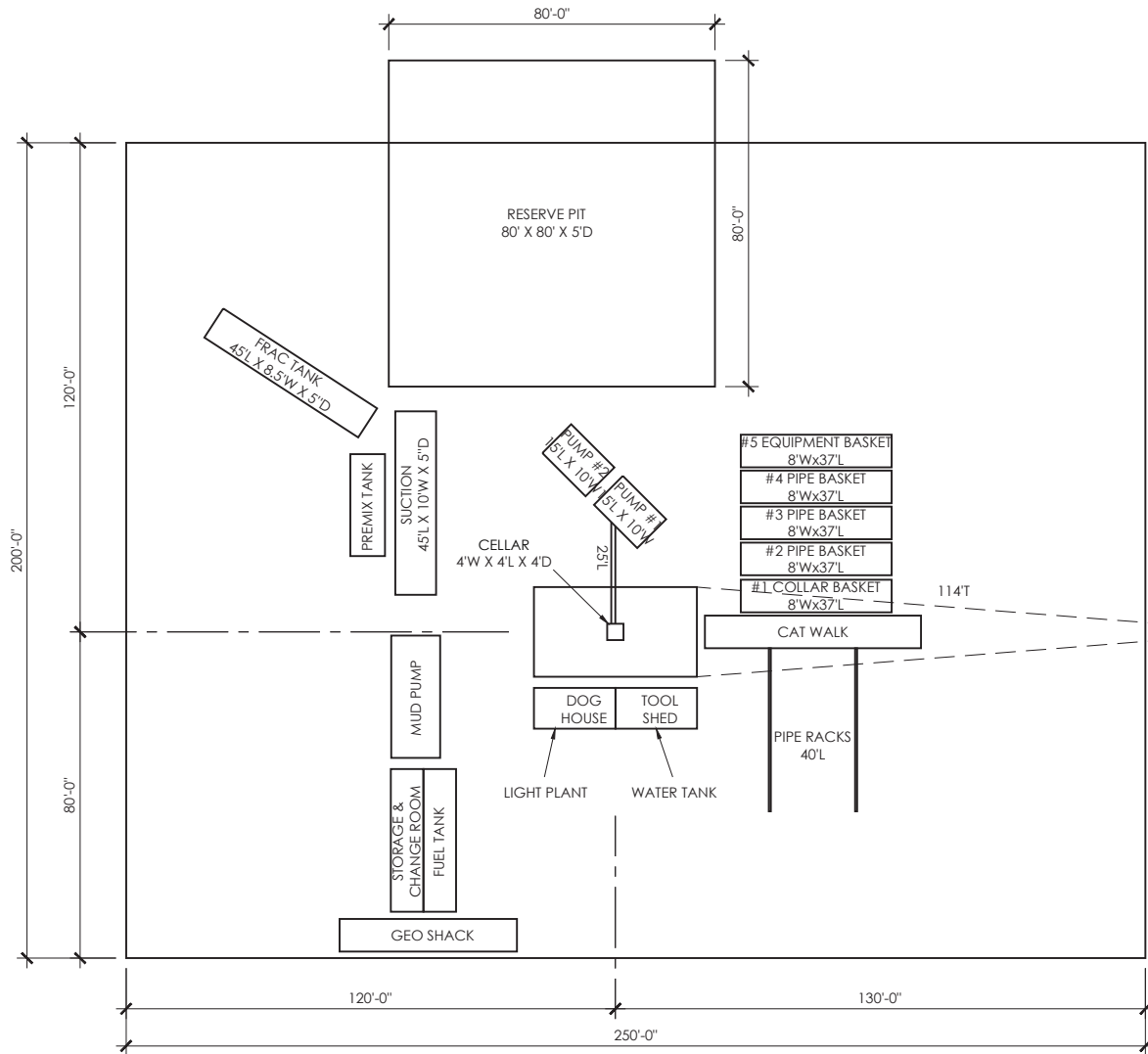

250' x 200'
Rig #114 with Earth Pits
KB 8'