



RIG #7

RATED TO 6000'

LOCATION SIZE

- 270' x 220'

DRAW WORKS

- RATED: 600HP
- IDECO H-35 S W/15" DOUBLE HYDRO 400HP
- CAT C-16

MAST

- 102' BUTLER-PARKS
- 310,000 STATIC HOOK LOAD

SUBSTRUCTURE

- 30" WINGS
- KB 5'

MUD PUMPS

- EMSCO D-375
- Cat C-16 600HP

MUD SYSTEM

- 100 BBLS PREMIX

TABLE

- NATIONAL C-175-S 250 TON

SWIVEL

- KING MODEL 15MB 150 TON

WATER TANK

- 320 BBLS CAPACITY

FUEL TANK

- 4000 GAL

POWER

- Cat 3406 225 KW



RIG #7

RATED TO 6000'

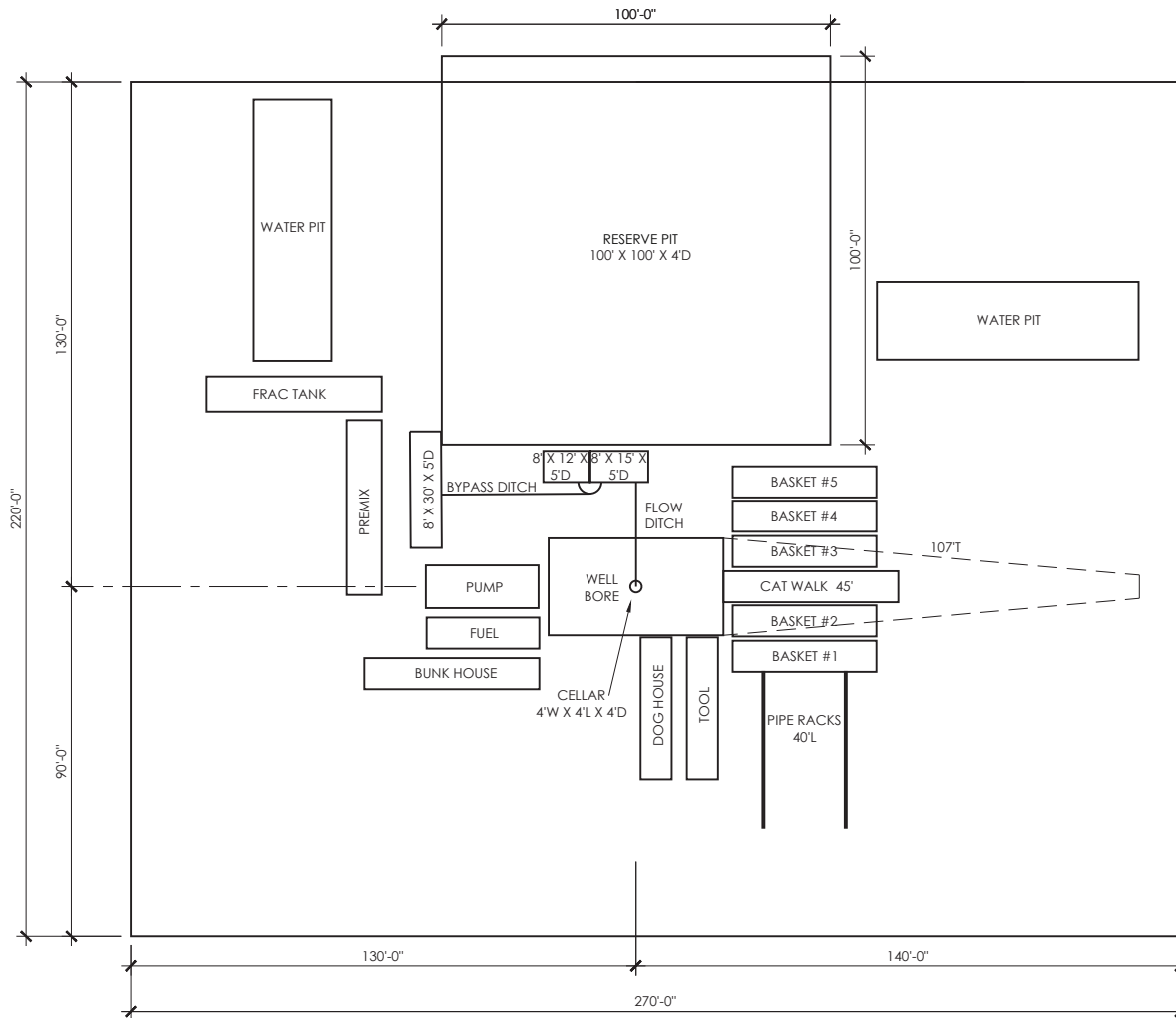

1" = 40'-0"
0 10' 20'

270' x 220'
Rig #7
KB 5'